

Pressacavi metallici

Metallic cable glands



Impiego - Use

La nostra linea di pressacavi metallici è caratterizzata da una particolare geometria costruttiva che garantisce una distribuzione uniforme della forza di compressione sul cavo avendo una ampia superficie di contatto con la guarnizione ampia e progettata per un impiego costante ed affidabile. Questi pressacavi, completi di o-ring sul filetto, sono prodotti in versione con filettatura corta e lunga ed assicurano una tenuta sicura sia montati con controgghiera che avvitati direttamente sul foro filettato della parete del quadro. L'anello di tenuta ha una buona resistenza chimica e garantisce una classe di protezione fino a IP 68. L'ampio elemento esagonale che costituisce la ghiera facilita il montaggio sia nella fase iniziale a mano che successivamente con la chiave di serraggio.

Our metallic cable glands are produced with a particular geometry that assures an equal cable compression having a large clamping and sealing areas designed for a secure and flexible everyday use. These cable glands, supplied with the o-ring on thread side, are produced with a short or long thread for secure fastening with thread or counter nut. The elastic sealing rings have a good chemical resistance and they provide a reliable seal with a guaranteed IP 68 protection class. The large hexagonal element of the screw-down nuts ensures consistently reliable and secure hold when turning by hand and tightening with the tool.



Dati Tecnici - Technical data

Caratteristica - Characteristics	Valore/proprietà - Value/property
Materiale <i>Material</i>	Ottone nichelato <i>Nickel-plated brass</i>
Materiale dell'anello di tenuta <i>Sealing ring material</i>	TPE, elemento singolo <i>TPE, one-piece.</i>
Materiale dell'o-ring <i>O-ring material</i>	NBR
Temperatura di esercizio <i>Temperature range</i>	-40°C, +100°C
Grado di protezione <i>Protection class</i>	IP 68

Codifiche e dimensioni - Coding and dimensions

Pressacavo dritto - Straight cable gland

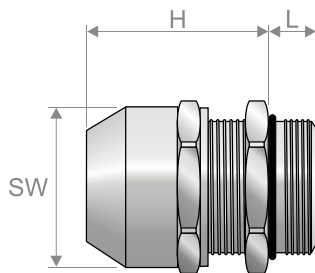

Codice <i>Code</i>	Filetto <i>Thread</i>	Chiave di serraggio <i>Tightening key</i> SW [mm]	Diametro del cavo <i>cable diameter</i> Min/Max [mm]	Dimensioni <i>Sizes</i> [mm]		Confezione <i>Packaging</i> [pz]	Nota <i>Note</i>
				H	L		
PCM100_M012X010	M12x1,5	15	1,0÷5,0	17,0	5,0	50	(1)
PCM100_M012X020	M12x1,5	15	3,0÷7,0	17,0	5,0	50	(1)
PCM100_M016X010	M16x1,5	18	2,0÷6,0	20,0	5,0	50	(1)

RACCORDI E SISTEMI PASSACAVO - FITTINGS AND CABLE ENTRY SYSTEMS

Codice Code	Filetto Thread	Chiave di serraggio Tightening key SW [mm]	Diametro del cavo cable diameter Min/Max [mm]	Dimensioni Sizes [mm]		Confezione Packaging [pz]	Nota Note
				H	L		
PCM100_M016X020	M16x1,5	18	4,5÷10,0	20,0	5,0	50	(1)
PCM100_M020X010	M20x1,5	22	3,5÷8,0	25,0	6,0	50	(1)
PCM100_M020X020	M20x1,5	22	7,0÷13,0	25,0	6,0	50	(1)
PCM100_M025X010	M25x1,5	28	5,0÷11,0	31,0	7,0	25	(1)
PCM100_M025X020	M25x1,5	28	10,0÷17,0	31,0	7,0	25	(1)
PCM100_M032X010	M32x1,5	36	7,0÷15,0	33,0	8,0	25	(1)
PCM100_M032X020	M32x1,5	36	13,0÷21,0	33,0	8,0	25	(1)
PCM100_M040X010	M40x1,5	46	15,0÷23,0	40,0	8,0	10	(1)
PCM100_M040X020	M40x1,5	46	19,0÷28,0	40,0	8,0	10	(1)
PCM100_M050X010	M50x1,5	55	20,0÷29,0	40,0	9,0	5	(1)
PCM100_M050X020	M50x1,5	55	25,0÷35,0	40,0	9,0	5	(1)
PCM100_M063X010	M63x1,5	70	28,0÷39,0	43,0	10,0	5	(1)
PCM100_M063X020	M63x1,5	70	35,0÷48,0	43,0	10,0	5	(1)
PCM100_P007X010	Pg 7	15	1,0÷5,0	17,0	5,0	50	(3)
PCM100_P007X020	Pg 7	15	3,0÷7,0	17,0	5,0	50	(3)
PCM100_P009X010	Pg 9	18	2,0÷6,0	20,0	6,0	50	(3)
PCM100_P009X020	Pg 9	18	4,5÷10,0	20,0	6,0	50	(3)
PCM100_P011X010	Pg 11	22	3,5÷8,0	25,0	6,0	50	(3)
PCM100_P011X020	Pg 11	22	7,0÷13,0	25,0	6,0	50	(3)
PCM100_P013X010	Pg 13	22	3,5÷8,0	25,0	6,5	50	(3)
PCM100_P013X020	Pg 13	22	7,0÷13,0	25,0	6,5	50	(3)
PCM100_P016X010	Pg 16	24	3,5÷8,0	25,0	6,5	50	(3)
PCM100_P016X020	Pg 16	24	5,0÷11,0	25,0	6,5	25	(3)
PCM100_P016X030	Pg 16	28	7,0÷13,0	31,0	6,5	50	(3)
PCM100_P016X040	Pg 16	28	10,0÷17,0	31,0	6,5	25	(3)
PCM100_P021X010	Pg 21	36	7,0÷15,0	33,0	7,0	25	(3)
PCM100_P021X020	Pg 21	36	13,0÷21,0	33,0	7,0	25	(3)
PCM100_P029X010	Pg 29	46	15,0÷23,0	40,0	8,0	10	(3)
PCM100_P029X020	Pg 29	46	19,0÷28,0	40,0	8,0	10	(3)
PCM100_P036X010	Pg 36	55	20,0÷29,0	40,0	9,0	5	(3)
PCM100_P036X020	Pg 36	55	25,0÷35,0	40,0	9,0	5	(3)
PCM100_P042X010	Pg 42	55	20,0÷29,0	40,0	10,0	5	(3)
PCM100_P042X020	Pg 42	55	25,0÷35,0	40,0	10,0	5	(3)
PCM100_P048X010	Pg 48	70	28,0÷39,0	43,0	10,0	5	(3)
PCM100_P048X020	Pg 48	70	35,0÷48,0	43,0	10,0	5	(3)

(1) Certificato c(UR)us / c(UR)us certified

(3) Non certificato c(UR)us / Not c(UR)us certified

Pressacavo diritto lungo - Long straight cable gland

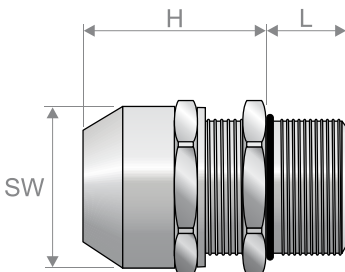

Codice Code	Filetto Thread	Chiave di serraggio Tightening key SW [mm]	Diametro del cavo cable diameter Min/Max [mm]	Dimensioni Sizes [mm]		Confezione Packaging [pz]	Nota Note
				H	L		
PCM101_M012X010	M12x1,5	15	1,0÷5,0	17,0	12,0	50	(1)
PCM101_M012X020	M12x1,5	15	3,0÷7,0	17,0	12,0	50	(1)
PCM101_M016X010	M16x1,5	18	2,0÷6,0	20,0	12,0	50	(1)
PCM101_M016X020	M16x1,5	18	4,5÷10,0	20,0	12,0	50	(1)
PCM101_M020X010	M20x1,5	22	3,5÷8,0	25,0	12,0	50	(1)
PCM101_M020X020	M20x1,5	22	7,0÷13,0	25,0	12,0	50	(1)

Codice Code	Filetto Thread	Chiave di serraggio Tightening key SW [mm]	Diametro del cavo cable diameter Min/Max [mm]	Dimensioni Sizes [mm]		Confezione Packaging [pz]	Nota Note
				H	L		
PCM101_M025X010	M25x1,5	28	5,0÷11,0	31,0	12,0	25	(1)
PCM101_M025X020	M25x1,5	28	10,0÷17,0	31,0	12,0	25	(1)
PCM101_M032X010	M32x1,5	36	7,0÷15,0	33,0	15,0	25	(1)
PCM101_M032X020	M32x1,5	36	13,0÷21,0	33,0	15,0	25	(1)
PCM101_M040X010	M40x1,5	46	15,0÷23,0	40,0	15,0	10	(1)
PCM101_M040X020	M40x1,5	46	19,0÷28,0	40,0	15,0	10	(1)
PCM101_M050X010	M50x1,5	55	20,0÷29,0	40,0	15,0	5	(1)
PCM101_M050X020	M50x1,5	55	25,0÷35,0	40,0	15,0	5	(1)
PCM101_M063X010	M63x1,5	70	28,0÷39,0	43,0	15,0	5	(1)
PCM101_M063X020	M63x1,5	70	35,0÷48,0	43,0	15,0	5	(1)
PCM101_M063X030	M63x1,5	80	44,0÷55,0	43,0	15,0	5	(1)

(1) Certificato c(UR)us / c(UR)us certified

Ghiera sottile - Thin lock nut

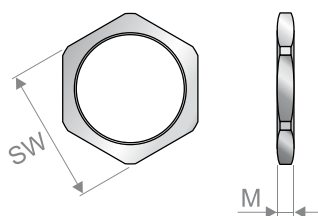

Codice Code	Filetto Thread	Chiave di serraggio Tightening key SW [mm]	Dimensioni Sizes [mm]		Confezione Packaging [pz]
			M		
PCFM10_M012	M12x1,5	15	3,0		100
PCFM10_M016	M16x1,5	19	3,0		100
PCFM10_M020	M20x1,5	24	3,5		100
PCFM10_M025	M25x1,5	30	4,0		50
PCFM10_M032	M32x1,5	36	4,0		25
PCFM10_M040	M40x1,5	46	5,0		25
PCFM10_M050	M50x1,5	55	5,5		10
PCFM10_M063	M63x1,5	70	6,0		10
PCFM10_M075	M75x1,5	80	6,0		10
PCFM10_M080	M80x2,0	95	8,0		5
PCFM10_M085	M85x2,0	95	8,0		5
PCFM10_M095	M95x2,0	110	9,0		5
PCFM10_M100	M100x3,0	115	9,0		1
PCFM10_M105	M105x3,0	120	9,0		1
PCFM10_M115	M115x3,0	125	10,0		1
PCFM10_P007	Pg 7	15	3,0		50
PCFM10_P009	Pg 9	18	3,0		50
PCFM10_P011	Pg 11	21	3,0		50
PCFM10_P013	Pg 13	23	3,0		50
PCFM10_P016	Pg 16	26	3,0		50
PCFM10_P021	Pg 21	32	3,5		25
PCFM10_P029	Pg 29	41	4,0		10
PCFM10_P036	Pg 36	51	5,0		10
PCFM10_P042	Pg 42	60	5,0		10
PCFM10_P048	Pg 48	64	5,5		10

Ghiera spessa - Thick lock nut

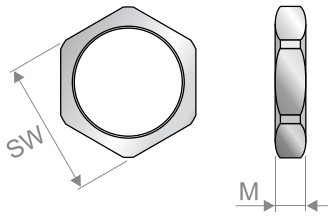

Codice Code	Filetto Thread	Chiave di serraggio Tightening key SW [mm]	Dimensioni Sizes [mm] M	Confezione Packaging [pz]
PCFM12_M012	M12x1,5	15	5,0	50
PCFM12_M016	M16x1,5	19	5,0	50
PCFM12_M020	M20x1,5	24	5,5	50
PCFM12_M025	M25x1,5	30	5,5	50
PCFM12_M032	M32x1,5	36	6,0	50
PCFM12_M040	M40x1,5	46	7,0	50
PCFM12_P007	Pg 7	15	5,0	50
PCFM12_P009	Pg 9	18	5,0	50
PCFM12_P011	Pg 11	21	5,0	50
PCFM12_P013	Pg 13	24	5,5	50
PCFM12_P016	Pg 16	26	5,5	50
PCFM12_P021	Pg 21	32	6,0	50
PCFM12_P029	Pg 29	41	7,0	50

Composizione del codice - Code composition

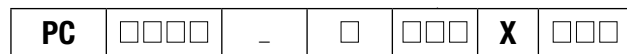

Famglia
Family

Codice identificativo della famiglia di pressacavi.
Code depending on the glands' family.

Versione Version	Inserire To be interted
Metric	M
PG	P

Filetto Thread	Inserire To be interted
M12, M16, ..., M63	012, 016, ..., 063
Pg 7, Pg 9, ..., Pg 48	007, 009, ..., 048

Range di diametri
Diameter range

Codice identificativo del range di diametri di accoppiamento.
Code depending on the cable range.

Ghiera - Lock nut



Famglia
Family

Codice identificativo della famiglia di ghiera.
Code depending on the lock nuts' family.

Versione Version	Inserire To be interted
Metric	M
PG	P

Filetto Thread	Inserire To be interted
M12, M16, ..., M63	012, 016, ..., 063
Pg 7, Pg 9, ..., Pg 48	007, 009, ..., 048